

# Break-Away™ Bike

## Recommended Assembly/Disassembly Instructions

This is Ritchey's recommended assembly and disassembly procedures. You may find a sequence that you are more comfortable with. To ensure your safety, it is your responsibility to verify the bike has been properly assembled, adjusted, and is in proper working order before riding.



**CAUTION:** User should periodically check and tighten the two set screws on each cable connector to ensure they are tight. Also ensure cable connectors are tight.

### ► ASSEMBLY INSTRUCTIONS

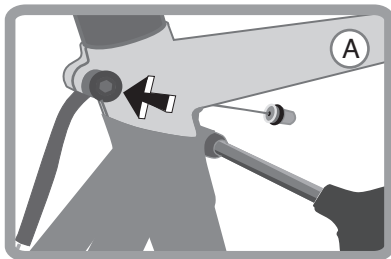

**STEP 1: (Figure A)**  
Align front and rear frame sections and insert seatpost keeping bolts loose.

**STEP 2: (Figure B)**  
Align lower frame and loosely install lower clamp. Do not use grease or oil on clamp.

**STEP 3:**  
Install rear wheel and tighten rear brake quick-release.

**STEP 4:**  
Install stem/bar assembly and top cap

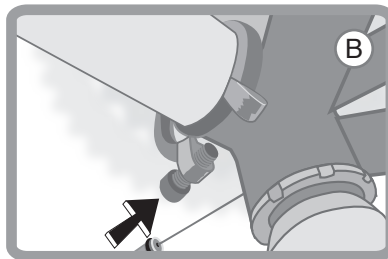

**STEP 5:**  
Install front brake caliper (if removed) and front wheel.

**STEP 6:**  
Tighten lower frame clamp. Make sure clamp is tight, but does not bottom out (minimum .5mm gap)

**STEP 7:**  
Tighten seatpost clamp bolts.

**STEP 8: (Figure C)**  
Assemble quick connect cables.

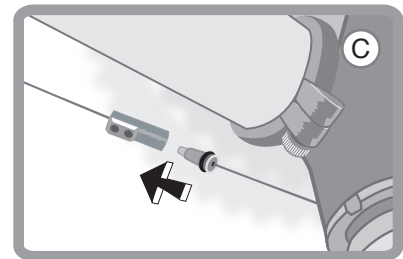

**STEP 9:**  
Adjust headset and tighten stem bolts.

**STEP 10:**  
Adjust seatpost height.

**STEP 11:**  
Install pedals and/or crank arm if removed.

**STEP 12:**  
Final check over, be sure all bolts are tightened properly and that all cables are assembled correctly. Test brakes before riding.

### ► DISASSEMBLY INSTRUCTIONS

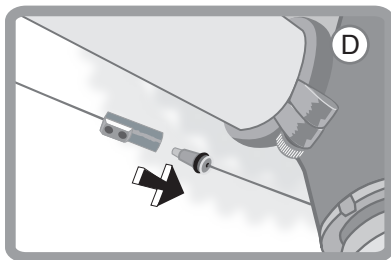

**STEP 1: (Optional)**  
Remove pedals and/or left crank arm

**STEP 2: (Figure D)**  
Disconnect cables using quick connect fittings

**STEP 3: (Figure E)**  
Loosen seatpost clamp bolts and lower clamp bolt, but do not remove.

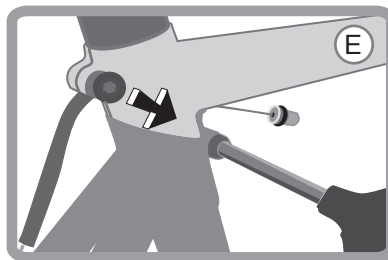

**STEP 4:**  
Loosen stem bolts and remove top cap.

**STEP 5:**  
Remove stem/bar assembly. (Optional): Loosen and remove front brake caliper.

**STEP 6:**  
Remove front wheel.

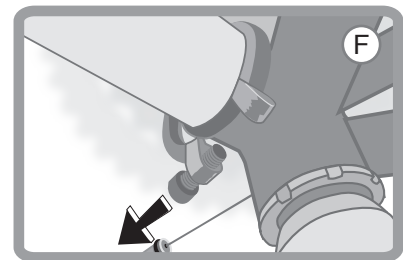

**STEP 7:**  
Loosen rear brake caliper quick release and remove rear wheel.

**STEP 8:**  
Remove seatpost.

**STEP 9: (Figure F)**  
Remove lower clamp and separate frame.